

MS
STATE OF ALASKA
DEPARTMENT OF COMMUNITY
AND REGIONAL AFFAIRS

BOOK 38 PAGE 241
Fairbanks City Dist.

I, BYRON I. MALLOTT, Commissioner, of the Department of Community and Regional Affairs, do hereby certify that the attached recommendation for a local government boundary change entitled

Recommendation for Changing the
Corporate Boundaries of the City
of Kotzebue

became effective on March 5, 1972.

A PETITION requesting the annexation of adjoining territory east, north and south of their corporate limits was submitted by the City of Kotzebue and received by the Department of Community and Regional Affairs on September 23, 1971. The Department immediately conducted an investigation of the petition. The Department requested and received permission from the petitioner to redefine the territory sought to be annexed by using USGS, 1:63,360 quadrangles. The Department completed its investigation of the petition and the Local Boundary Commission called for and held a public hearing in Kotzebue on December 1, 1971. A formal business meeting was held by the Commission in Anchorage on December 5, 1971, at which time it was voted to alter the boundaries sought by the petitioner; to accept the amended petition, and to recommend to the legislature the boundary change presented therein.

THE COMMISSION'S recommendation was presented to the state legislature pursuant to Section 12, Article 10 of the Constitution of the State of Alaska:

Section 12. Boundaries. A local boundary commission or board shall be established by law in the executive branch of the state government. The Commission or board may consider any proposed local government boundary change. It may present proposed changes to the legislature during the first ten days of any regular session. The change shall become effective forty-five days after presentation or at the end of the session, whichever is earlier, unless disapproved by a resolution concurred in by a majority of the members of each house. . .

THE SECOND SESSION of the Seventh State Legislature received the Commission's recommendation on January 19, 1972, the tenth day of

the legislative session. No resolutions requesting legislative dis-approval of the Commission's recommendation were introduced. The Local Boundary Commission's "Recommendation for changing the Corporate Boundaries of the City of Kotzebue" became effective on March 5, 1972, the forty-sixth day after presentation to the legislature. The boundaries of the City of Kotzebue are now, therefore, as described by the Local Boundary Commission's recommendation, to wit:

Beginning at a point where the S boundary of Section 35, Unsurveyed T17N, R18W, Kateel River Meridian, Alaska, intersects the mean low water line of Kotzebue Sound; thence E to the SE corner of the SW 1/4 of the SW 1/4 of the SW 1/4 of Section 31, Unsurveyed T17N, R17W; thence N to the NE corner of the NW 1/4 of the NW 1/4 of the NW 1/4 of Section 30, Unsurveyed T17N, R17W; thence E to the SW corner of the SE 1/4 of the SE 1/4 of the SW 1/4 of Section 20, Unsurveyed T17N, R17W; thence N to the NW corner of the NE 1/4 of the NE 1/4 of the NW 1/4 of Section 8, Unsurveyed T17N, R17W; thence W to the SW corner of Section 6, Unsurveyed T17N, R17W; thence N to the SW corner of the NW 1/4 of Section 6, Unsurveyed T17N, R17W; thence E to the SE corner of the NW 1/4 of Section 6, Unsurveyed T17N, R17W; thence N to the NE corner of the NW 1/4 of Section 6, Unsurveyed T17N, R17W; thence E to the SE corner of Section 33, Unsurveyed T18N, R17W; thence N to the point where the extension of the common boundary between Sections 33 and 34, Unsurveyed T18N, R17W, intersects the mean low water line of Hotham Sound; thence in a westerly northerly, southerly, westerly, and southerly direction along the mean low water line of Hotham Sound and Kotzebue Sound, to the point of beginning, containing 26.5 square miles, more or less.

GIVEN under my hand and the Seal of the State of Alaska, in the City and Borough of Juneau, on this 5th day of March, 1973.

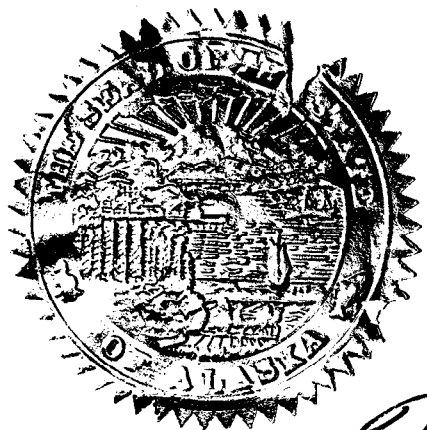

Raymond A. Malott
Commissioner
Department of Community and
Regional Affairs

ATTEST: P. O. Brubaker
Lieutenant Governor

INDEXED

7302725
N.C.
RECORDED-FILED
FAIRBANKS REC.
DISTRICT

MAR 21 1 31 PM '73
REQUESTED BY Dept. of Community &
ADDRESS Regional Affairs
Room B Juneau, Alaska

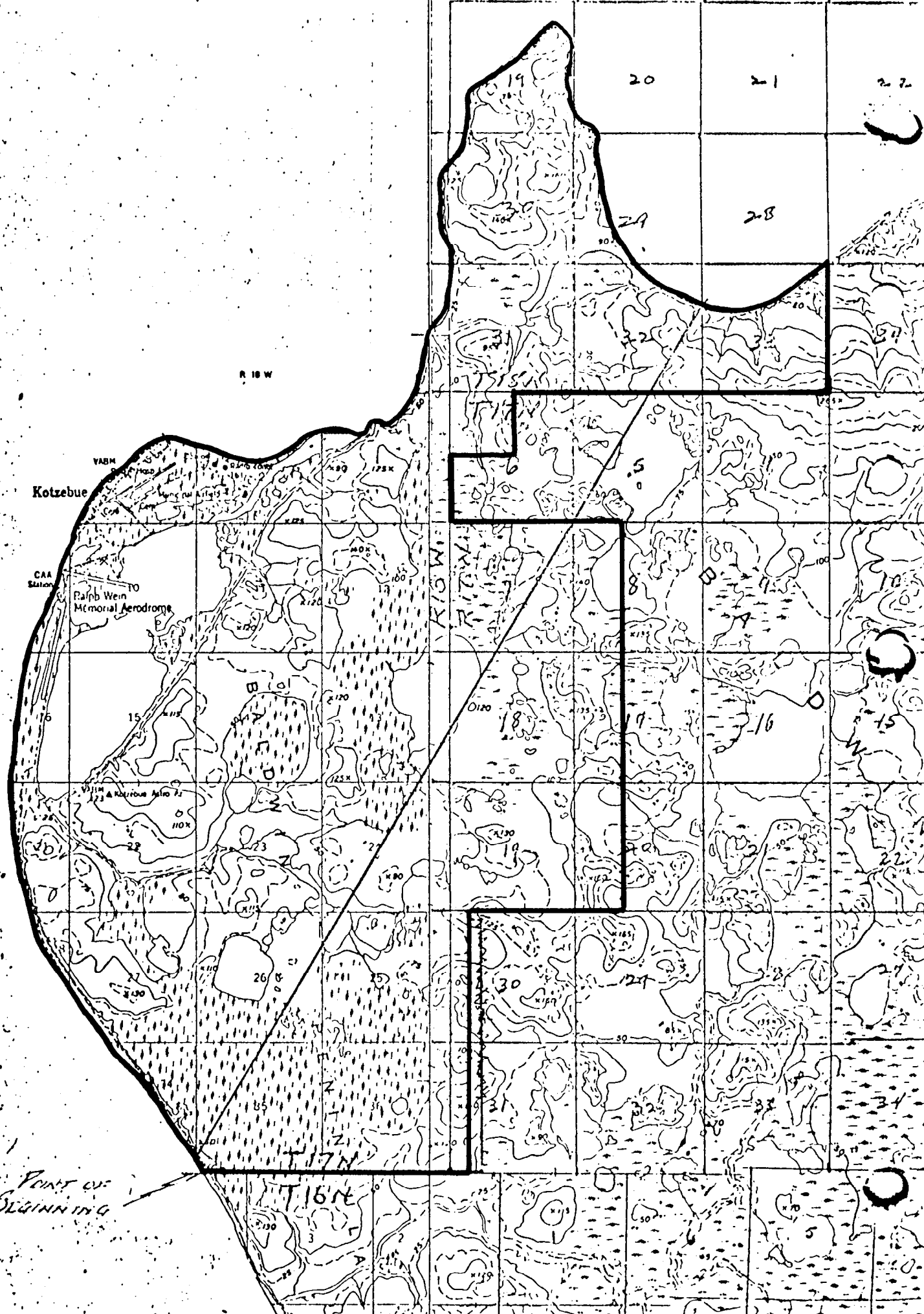

Kotzebue

CAA Station

Ralph Wein Memorial Aerodrome

VABM

POINT OF BEGINNING

R 18 W

K 10 W

T 16 N