



FLOOD HAZARD INFORMATION

SEE FIS REPORT FOR ZONE DESCRIPTIONS AND INDEX MAP THE INFORMATION DEPICTED ON THIS MAP AND SUPPORTING DOCUMENTATION ARE ALSO AVAILABLE IN DIGITAL FORMAT AT [HTTP://MSC.FEMA.GOV](http://msc.fema.gov)

SPECIAL FLOOD HAZARD AREAS		Without Base Flood Elevation (BFE) Zone A, V, A99
		With BFE or Depth Zone AE, AO, AH, VE, AR
		Regulatory Floodway
OTHER AREAS OF FLOOD HAZARD		0.2% Annual Chance Flood Hazard, Areas of 1% annual chance flood with average depth less than one foot or with drainage areas of less than one square mile Zone X
		Future Conditions 1% Annual Chance Flood Hazard Zone X
		Area with Reduced Flood Risk due to Levee See Notes. Zone X
OTHER AREAS		Areas Determined to be Outside the 0.2% Annual Chance Floodplain Zone X
		Area of Undetermined Flood Hazard Zone D
GENERAL STRUCTURES		Channel, Culvert, or Storm Sewer
		Accredited or Provisionally Accredited Levee, Dike, or Floodwall
		Non-accredited Levee, Dike, or Floodwall
OTHER FEATURES		Cross Sections with 1% Annual Chance Water Surface Elevation (BFE) 18.2 17.5
		Coastal Transect
		Coastal Transect Baseline
		Profile Baseline
		Hydrographic Feature
		Base Flood Elevation Line (BFE)
		Limit of Study
		Jurisdiction Boundary

NOTES TO USERS

For information and questions about this map, available products associated with this FIRM including historic versions of this FIRM, how to order products or the National Flood Insurance Program in general, please call the FEMA Map Information eXchange at 1-877-FEMA-MAP (1-877-336-2627) or visit the FEMA Map Service Center website at <http://msc.fema.gov>. Available products may include previously issued Letters of Map Change, a Flood Insurance Study Report, and/or digital versions of this map. Many of these products can be ordered or obtained directly from the website. Users may determine the current map date for each FIRM panel by visiting the FEMA Map Service Center website or by calling the FEMA Map Information eXchange.

Communities annexing land on adjacent FIRM panels must obtain a current copy of the adjacent panel as well as the current FIRM Index. These may be ordered directly from the Map Service Center at the number listed above.

For community and countywide map dates refer to the Flood Insurance Study report for this jurisdiction.

To determine if flood insurance is available in the community, contact your insurance agent or call the National Flood Insurance Program at 1-800-638-6620.

Base map information shown on this FIRM was provided in digital format by the United States Geological Survey (USGS). This information was derived from digital orthophotography at a 2-foot resolution from photography dated 2010.

SCALE

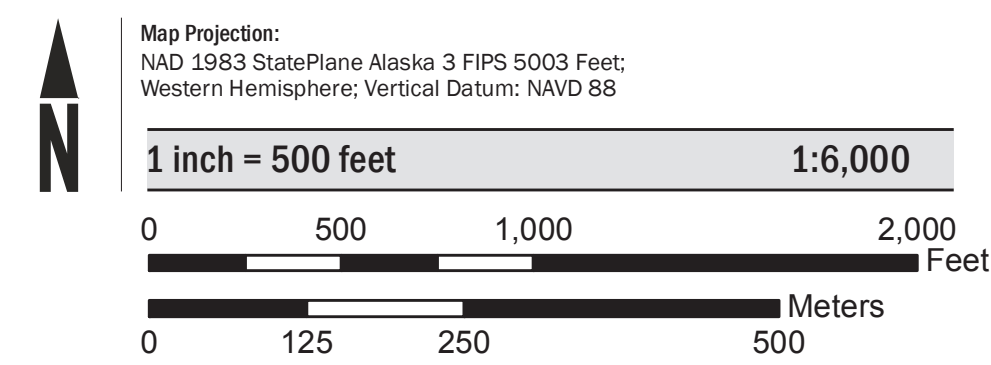

PANEL LOCATOR

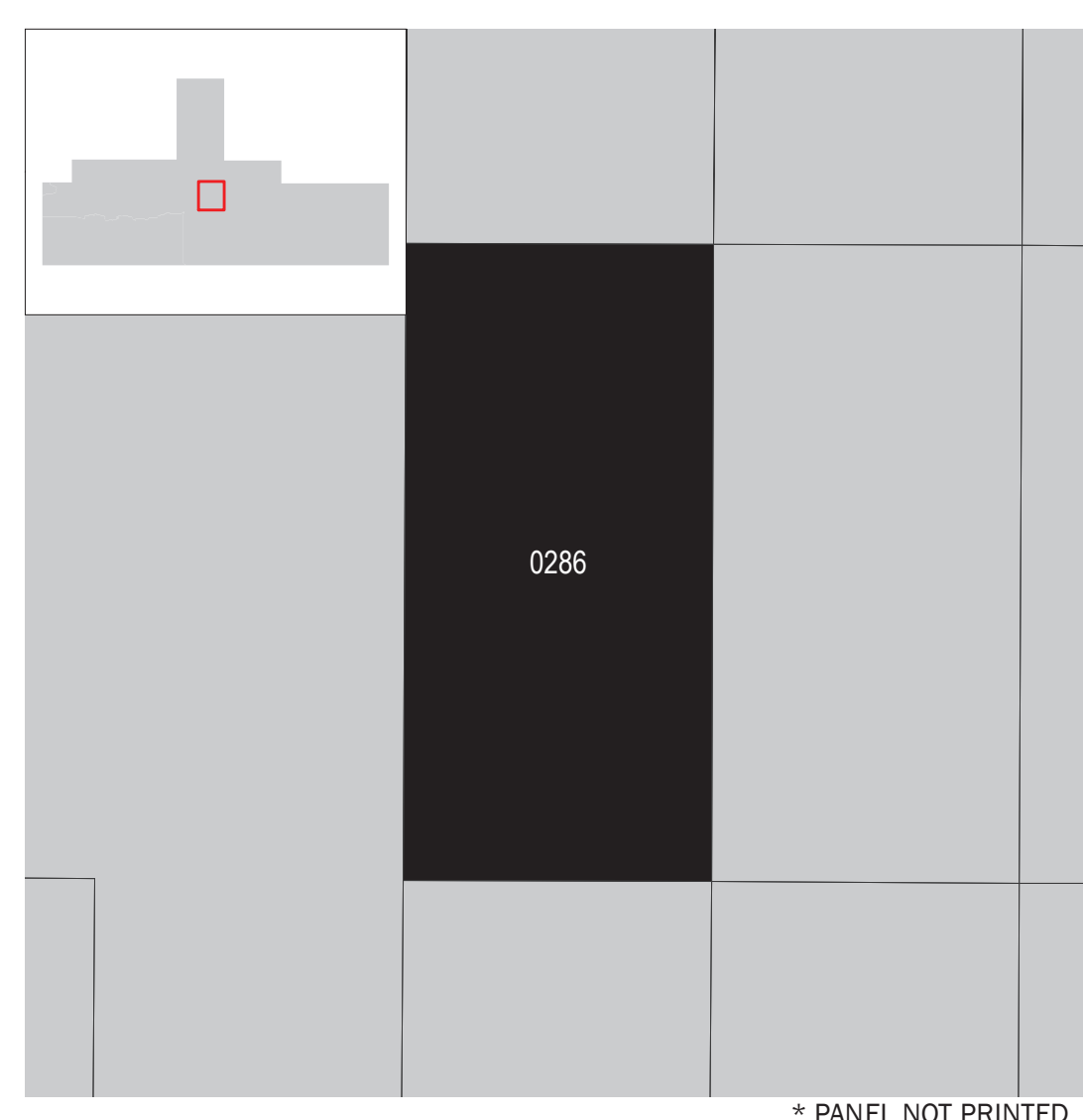

**NATIONAL FLOOD INSURANCE PROGRAM
FLOOD INSURANCE RATE MAP**

CITY OF VALDEZ, AK
VALDEZ - CORDOVA CENSUS AREA
PANEL 286 of 400



Panel Contains:

COMMUNITY	NUMBER	PANEL	SUFFIX
VALDEZ, CITY OF	020094	0286	D

**PRELIMINARY
9/15/2016**

VERSION NUMBER
2.3.2.2
MAP NUMBER
0200940286D
EFFECTIVE DATE